

# ICE CREAM

## DIMENSIONS

3500 x 2400 x 2400 mm (length x width x height)

## DESCRIPTION

This slight trailer is ready for selling waffles, ice cream, juice and beverages. Depending on requirements the equipment may include: ice cream machine, waffle maker, whipped cream machine, juice squeezer, crepes machine, etc. Graphic design of the trailer appearance is individually prepared with an emphasis on the attractiveness to customers. An interior of the trailer is completely finished with the stainless steel sheet and furniture are made of durable chipboard MDF. The trailer has two flaps (front and side) and masking cover for wheels in order to give more stationary look to the trailer.

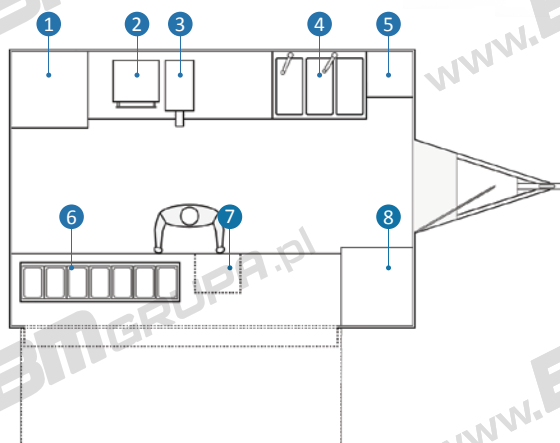

## EQUIPMENT

- ① Ice cream machine
- ② Waffle maker
- ③ Automatic whipped cream
- ④ Sanitary station
- ⑤ Wardrobe
- ⑥ Cooling Extension
- ⑦ Cashbox
- ⑧ Refrigerator





# COFFEE AND SWEETS

## DIMENSIONS

3500 x 2400 x 2400 mm (length x width x height)

## DESCRIPTION

The trailer is adapted for the coffee and sweets. It has two flaps (front and side) and covers for masking the wheels, that contribute to aesthetic of whole object. It is equipped with furniture and devices which are the most suitable for that sort of food and it is individually selected to your requirements. There are professional machines inside for making ice cream, mini donuts, whipped cream and waffles. Moreover, there are also a cooling glass-case for beverages and a cooling bar for dessert additives. Colourful veneer is printed with individually prepared graphic design and it attractively presents delicacies sold in the trailer. This is an extremely effective element of advertising. For advertising reason there is also a lighted banner mounted on the roof. In addition, menu is presented by ultra-thin backlit panels, which are mounted on the hood.

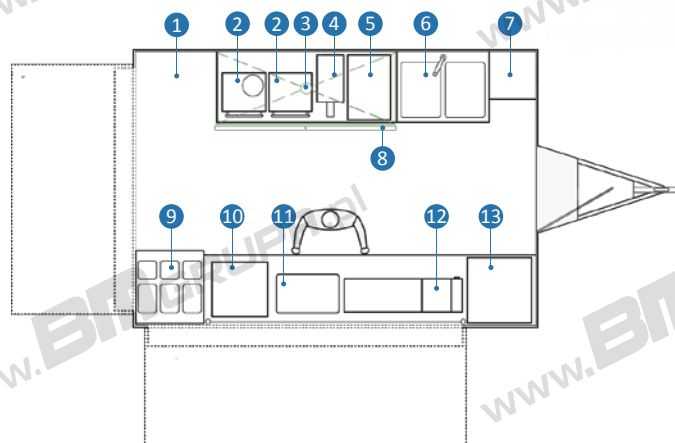

## EQUIPMENT

- |                               |                                  |
|-------------------------------|----------------------------------|
| 1 Place for ice cream machine | 8 LED Coffee                     |
| 2 Waffel maker                | 9 Salad bar                      |
| 3 Hood                        | 10 Cashbox                       |
| 4 Carem Whipper               | 11 Container for donuts          |
| 5 Coffee express              | 12 Donuts machine                |
| 6 Sanitary station            | 13 Cooling vitrine for beverages |
| 7 Wardrobe                    |                                  |





# GRILL

## DIMENSIONS

3500 x 2400 x 2400 mm (length x width x height)

## DESCRIPTION

This mobile beanery serves traditional dishes and grilled dishes. It is equipped with a large coal grate, stainless steel furniture and durable chipboard furniture. The location of the grill - close to sales window - allows customers to choose the appropriate baked morsel, but glass screen effectively protect them against the heat of the hearth. A veneer depicting the grilled meat attracts potential customers before they feel the aroma of grilled pork or skewers. two flaps make this relatively small trailers a spacious gastronomic trailer, which encourages customers to satisfy their culinary wishes.

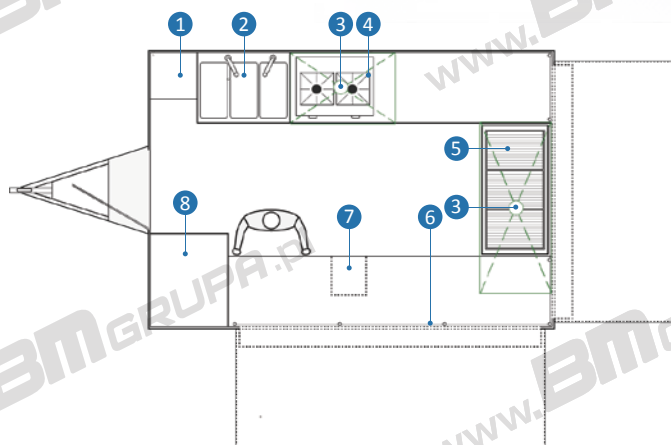

## EQUIPMENT

- ① Wardrobe
- ② Sanitary station
- ③ Hood
- ④ Gas stove
- ⑤ Coal grate
- ⑥ Short glass
- ⑦ Drawers
- ⑧ Refrigerator





# SAUSAGES

## DIMENSIONS

4000 x 2400 x 2400 mm (length x width x height)

## DESCRIPTION

Festivals, concerts, sport events and other events are the challenges that this trailer will surely meet. It is adapted for making and selling grilled sausages, hot dogs and currywurst. It has two flaps: front and side, which greatly improves sales and increases customer confidence by enabling them looking inside the trailer and observing the process of preparing food. The trailer gains customer appreciation also thanks to masking covers which can be mounted on wheels. A coloured veneer made with individual graphic design has been prepared at the discretion of the customer. They both affect the aesthetic appearance of the trailer.



## EQUIPMENT

- |                                |                              |
|--------------------------------|------------------------------|
| 1 Wardrobe                     | 8 Cutter for cutting sausage |
| 2 Sanitary station             | 9 Cashbox                    |
| 3 Top shelf with lightning     | 10 Electric fryer            |
| 4 Short glasses / high glasses | 11 Refrigerator              |
| 5 Refrigerated counter         | 12 Freezer                   |
| 6 Grill plate                  |                              |
| 7 Hood                         |                              |

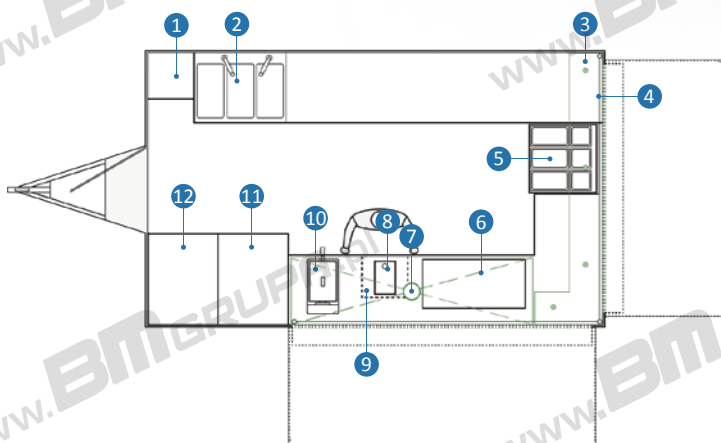



# HOT DOGI

## DIMENSIONS

4000 x 2400 x 2400 mm (length x width x height)

## DESCRIPTION

The trailer is designed for highly intense work! Large work area, ergonomic furniture with a large number of shelves and storage compartments provide large comfortable work staff. It attracts customers sight even when it is placed in the densest crowd, because of extra banners mounted on the roof, a colored veneer and an appetizing menu. An additional flap allows staff to rank work into purchasing part and serving part. You can serve customers by two windows at once, as well. Then the time to wait for a tasty snack is reduced. Any catering equipment can be installed inside the trailer, so hot dogs can be served in both the American style and French style.

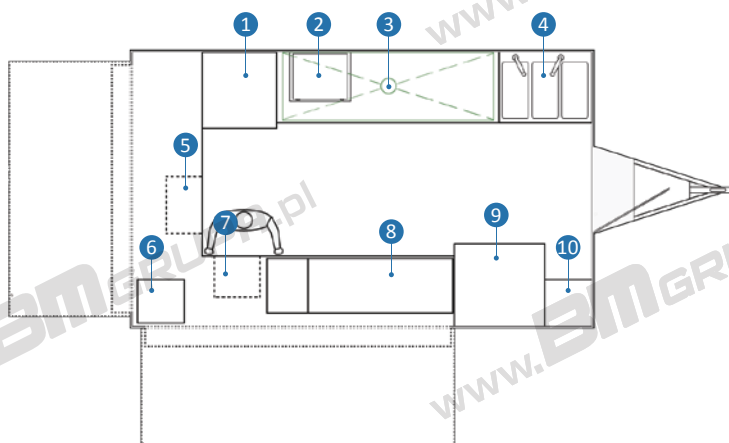

## EQUIPMENT

- 1 Exposition vitrine (glass door)
- 2 Toaster/ salamander on shelf
- 3 Hood
- 4 Sanitary station
- 5 Microwave under the table
- 6 Cooling vitrine for beverages
- 7 Cashbox
- 8 Cooling top
- 9 Freezer
- 10 Wardrobe





# PIZZA

## DIMENSIONS

5000 x 2400 x 2400 mm (length x width x height)

## DESCRIPTION

The trailer is suitable for the preparation and selling of pizza. It is equipped with a professional quality ovens with fireclay boards, a refrigerated table with a board for kneading dough and a cooling cabinet for ingredients storage. The undeniable advantage is that the pizza is prepared in front of the customers. The trailer has two flaps for customers and one additional flap built behind the oven in order to provide adequate air flow. The trailer is decorated with a foil depicting tasty pizza, while the roof has an illuminated advertising banner with the company logo.

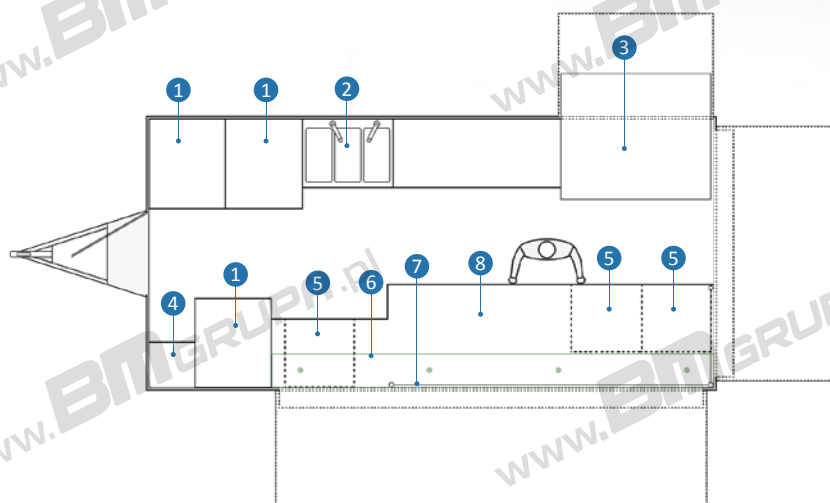

## EQUIPMENT

- 1 Refrigerator
- 2 Sanitary station
- 3 Pizza oven
- 4 Wardrobe
- 5 Undercounter refrigerator
- 6 Top shelf with lightning
- 7 Medium glasses
- 8 Working table





# MEAT, SEA FRUITS

## DIMENSIONS

5000 x 2400 x 2400 mm (length x width x height)

## DESCRIPTION

A well-stocked shop will meet the needs of its customers by presenting a full range of meats, fish or dairy products in a wide refrigerated counters. they allow customers to select a product without undue haste.

Trailer with high capacity storage (refrigerated cabinet and table) will not allow sellers to worry about store supply during all day.

Customers can verify product availability and its price on the LCD monitor, which are available for them all the time. The glass in the window is for keeping inside clean at the appropriate level. It is extremely important for this range of products. Moreover the glass window is a protection from of any weather conditions.

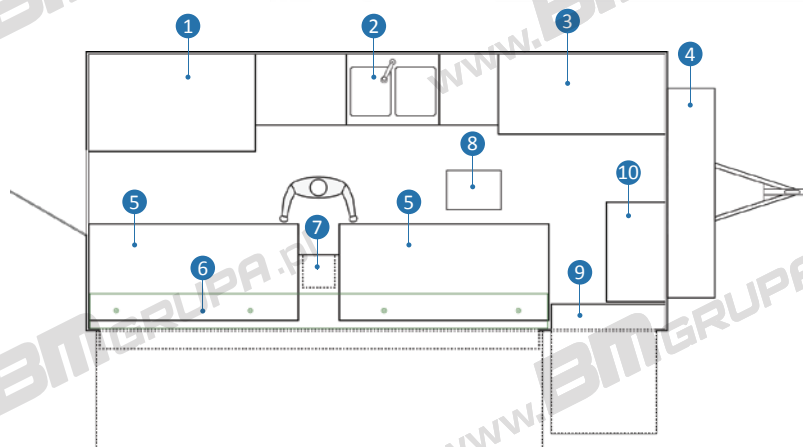

## EQUIPMENT

- 1 Freezer
- 2 Sanitary station
- 3 Freezing working table
- 4 Cupboard for gas bottles
- 5 Cooling vitrine, exposition
- 6 Top shelf with lightning
- 7 Cashbox
- 8 Air conditioning, heater
- 9 LED 32 in waterproof, burglar casing
- 10 Refrigerator





# FAST FOOD

## DIMENSIONS

5000 x 2400 x 2400 mm (length x width x height)

## DESCRIPTION

A true kitchen on wheels! There is an kitchen line of highly efficient catering equipment installed under the fume hood. It will allow customers to satisfy their appetites without waiting in long queue. The trailer is equipped with equipment to prepare hot dogs, fries, grilled foods, fried foods, traditional. There are also a refrigerated cabinet and a salad bar inside the this kitchen. The outer cabinet for gas bottles supplying heating appliances and a spacious freezing cabinet as a magazine allows you to work for several hours with a single gas supply and semi-finished food.



## EQUIPMENT

- |                             |   |
|-----------------------------|---|
| 1 Freezing cabinet 2-door   | 12 Cooling vitrine, exposition          |
| 2 Roller grill              | 13 Air conditioning, heater             |
| 3 Gas bain-marie            | 14 LED 32 in waterproof, burglar casing |
| 4 Double fryer              | 15 Sanitary station                     |
| 5 Hood                      |   |
| 6 Grill plate               |   |
| 7 Gas cooker                |   |
| 8 Cupboard for gas bottles  |   |
| 9 Salad bar                 |   |
| 10 Top shelf with lightning |   |
| 11 Cashbox                  |   |

